

Dew Point Sensor – K Series

For refrigerant or desiccant dryers with dew point of
-50°C to +20°C

Features:

- Dew Point Range:
-60°C to +60°C
(-76°F to +140°F)
- Accuracy +/- 2°C
- Gas systems up to 4 Mpa
(600psi)
- Up to four output signals
(i) Pressure Dew Point
(ii) Relative Humidity
(iii) Temperature and
(iv) Pressure (with
optional integrated
pressure sensor)
- Two outputs as standard
(i) Digital - Modbus and
(ii) Analog - 4-20mA
- Fast response time
- Includes Measuring
Chamber and M12
connector
- IP65 rated
- Options
(i) integrated pressure
sensor
(ii) 5m Cable
(iii) Multiple Gas options
(iv) In-Built Display
- Alarm relay – only
available on the 'Dew
Point Sensor with Display'



Standard Dew
Point Sensor

Dew Point Sensor
with Display

This precision dew point sensor is ideal for compressed air and inert gas systems up to 4 Mpa (600psi) with refrigerant, desiccant or membrane dryers.

The optional integrated pressure sensor makes measuring simpler and easier to manage, reducing wiring and installation costs.

With polymer technology and strong contamination resistance, sensor calibration can be performed every 2 years¹. The fast response time ensures an accurate and up to date reading, giving you peace of mind that your system is under control.

¹Provided sensor not exposed to relative humidity above 85%

More information: www.compressedairalliance.com/products

Benefits of dew point monitoring:

- Improve system reliability
- Reduce product contamination risks
- Reduce system maintenance
- Reduce operating and energy costs
- Improve dryer reliability
- Improve filter life and performance
- Reduce risk of rust and corrosion build up
- Reduce risk of bacteria, fungus and yeast build up
- Be aware of changes in dryer performance before moisture appears in your plant

Specifications

Sensor

Sensor Technology	Polymer sensor
Sensor Filter	Stainless steel mesh filter (filter grade 40-50 um)

Contact us for other filter options

Measurement Range

Pressure Dew Point Range	-60°C to +60°C (-76°F to +140°F)
Gas Temperature Measurement Range	-40 to +100 °C -40 to +212°F

Pressure Measurement Range	
• with pressure sensor	0 to 17 bar
• without pressure sensor	0 to 50 bar

Accuracy

Dew Point Accuracy	±2%
Temperature Accuracy	
• 0 to + 50°C	±0.3°C
• -40 to 0°C and +50 to +100°C	±0.5°C
Pressure Accuracy (@23°C)	±0.3% F.S
Pressure changes with temperature	±0.01 bar / 10°C

Dew Point Measurement Response Time

-50 to +20 °Ctd	20 sec [40 sec]
+20 to -50 °Ctd	1 min [3 min]

Reference Conditions: 63% [90%], 20 °C, 1bar(a),
4L/min

Working Environment

Ambient Temperature	-30 to +70°C -22 to +158°F
Relative Humidity	0 to 95% RH
Minimum gas flow	> 1L /min

Output

Outputs	4-20 mA (3 wire) Modbus RTU (RS485)
Current Output Resolution	0.002 mA
Current Output Temperature Drift	0.01% of span/°C
Current Output Load	Max 500 ohm

Alarm Relay Output	Not available
• Standard Dew Point Sensor	
• Sensor with Display	Normally open 32 VDC/500 mA

Connector	
• Standard Dew Point Sensor	1 x 5 pin M12, female
• Sensor with Display	2 x 5 pin M12, female

Power Supply

Power Requirement	10 ... 30 VDC
• Standard Dew Point Sensor	Max 50 mA @ 24 V
• Sensor with Display	16 ... 30 VDC Max 150 mA @ 24 V

Electromagnetic Compatibility	Meets IEC 61326-1
-------------------------------	-------------------

Other

Process Connection	G1/2" thread
--------------------	--------------

Contact us for UNF process connection

IP Rating	IP65
-----------	------

Casing	
• Standard Dew Point Sensor	Stainless Steel
• Sensor with Display	Anodised Aluminium

Display	
• Standard Dew Point Sensor	NA
• Sensor with Display	1.5" touch screen



Dimensions (mm)

Standard Dew Point Sensor

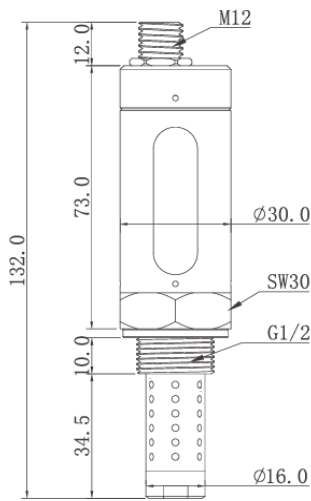

Dew Point Sensor with Display

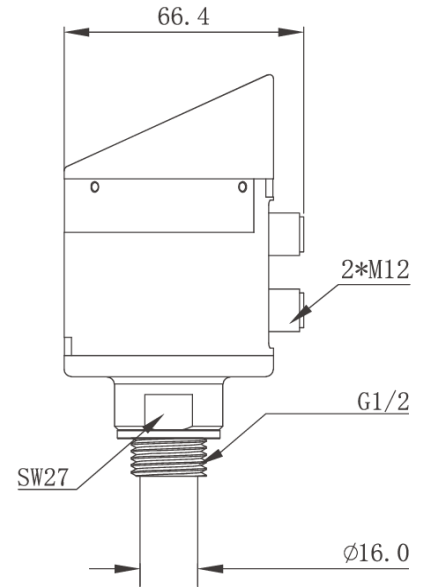
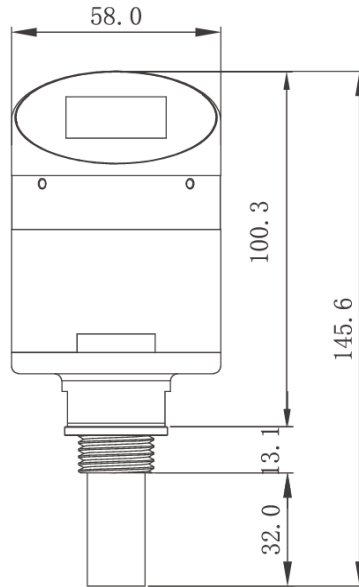

How to Order

Buy online: www.compressedairalliance.com/products

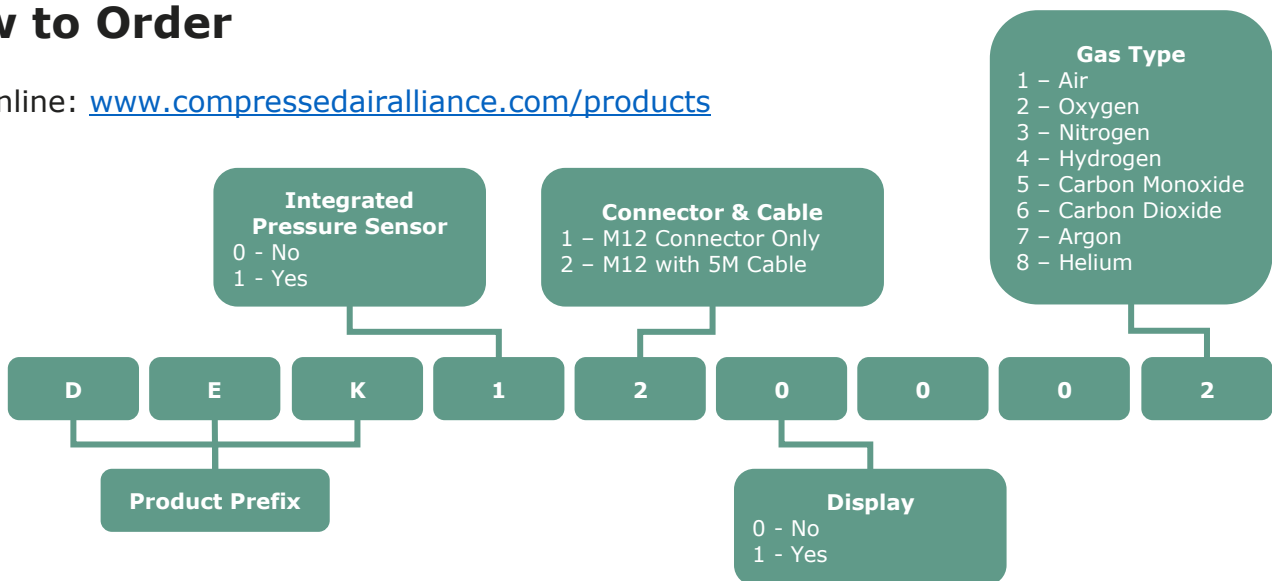

Other Dew Point Sensors



W Series Dew Point Sensor

Wall mount dew point monitor. Ideal for applications that require a large display or visual alarm

Pressure Dew Point Range

-110°C to +60°C (-166°F to +140°F)

Gas Contamination

Minimal to moderate contamination

Outputs

None. Stand alone unit

Technology

Quartz, Alumina-Oxide or Polymer sensor (depending on dew point range)

Options

Integrated pressure sensor

Power Plug (USA, Euro, UK or Australian plug)



Q Series Dew Point Sensor

"Top of the range" sensor

Pressure Dew Point Range

-110°C to +0°C (-166°F to +32°F)

Gas Contamination

High purity gases. Little to no contamination

Outputs

Modbus & 4-20mA

Technology

Quartz sensor technology

Options

Integrated pressure sensor, in-built display, data cable



Mini Dew Point Sensor

Entry level sensor. Compact design and can be used in small spaces

Pressure Dew Point Range

-60°C to +60°C (-76°F to +140°F)

Gas Contamination

Moderate levels of contamination

Outputs

Modbus & 4-20mA

Technology

Polymer sensor

Options

Stainless Steel or Aluminium casing

Note: No integrated pressure or in-built display option available



P Series Dew Point Meter

Portable dew point meter. Ideal for temporary measurement

Pressure Dew Point Range

-110°C to +60°C (-166°F to +140°F)

Gas Contamination

Minimal to moderate contamination

Outputs

None. Stand alone unit

Technology

Quartz, Alumina-Oxide or Polymer sensor (depending on dew point range)

Options

Integrated pressure sensor

Power Plug (USA, Euro, UK or Australian plug)